

# ClearOne®

## DIALOG® 20 Wireless Transmitters



## Contents:

<b>Setting up the system</b> .....	3
Box Contents .....	3
Set Up .....	3
<b>Syncing the Transmitters with the Receiver</b> .....	4
<b>Reading the Transmitter LCD</b> .....	4
<b>Reading Transmitter LED</b> .....	5

## Setting Up ClearOne DIALOG 20 Wireless Transmitters:

**Packing List:** Inspect your shipment carefully and verify contents. If the shipment shows signs of damage, retain original boxes and packing material for inspection by the carrier, and contact them immediately. ClearOne is not responsible for product damage incurred during shipment.

The contents of each transmitter package are listed below. The transmitters in your system will depend on the transmitters purchased for your DIALOG Wireless System.

### Box Contents:

#### DIALOG 20 Handheld Transmitter:

(Qty. 1) ... Handheld Microphone  
 (Qty. 2) ... Rechargeable, AA, NiMH batteries  
 (Qty. 1) ... Mic-stand Clip

#### DIALOG 20 Belt Pack Transmitter:

(Qty. 1) ... Beltpack Base Unit  
 (Qty. 2) ... Rechargeable, AA, NiMH batteries  
 (Qty. 1) ... Beltpack Antenna

#### DIALOG 20 Podium Transmitter:

(Qty. 1) Podium Base Unit with Battery Cassette  
 (Qty. 4) Rechargeable, AA, NiMH batteries  
 (Qty. 1) Gooseneck Microphone  
 (Qty. 1) Wind Screen

#### DIALOG 20 Boundary Transmitter:

(Qty. 1) ... Boundary Microphone  
 (Qty. 2) ... Rechargeable, AA, NiMH batteries

*DIALOG 20 Wireless Transmitters are compatible with DIALOG 10 and DIALOG 20 Receivers.*

### Set Up:

#### 1. Charge the Transmitters:

Transmitters include rechargeable batteries. Install the batteries, connect the USB-A to USB-Micro cable to the transmitter and plug it into a USB power source to charge the batteries (12 hrs is required for a full charge).

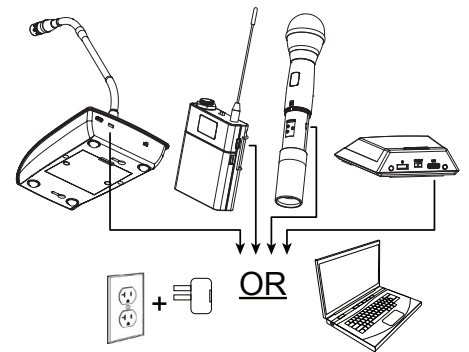

*Refer to the DIALOG 10 Receiver QSG for instructions on setting up the receiver.*

## Syncing Transmitters with Receiver:

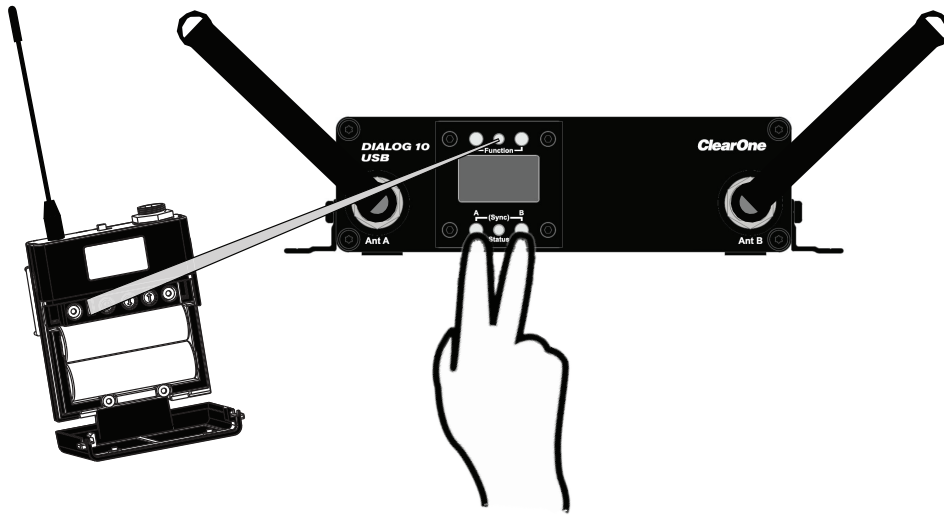

1. Simultaneously, press the two buttons on the bottom of the receiver module. "SCANNING" shows on the receiver's display for 5 to 10 seconds followed by "SYNCING".
  - a. To sync a Boundary Mic or Podium Mic:  
While the receiver shows "SYNCING", Press and hold the "Mute" button, power on the transmitter and then release the "Mute" button.
  - b. To sync a Handheld or Beltpack:  
While the receiver shows "SYNCING", Press and hold the "Select" button, power on the transmitter and then release the "Select" button.

*Both the transmitter and receiver display will read "SYNC PASS" when the sync is successful.*
2. Repeat the procedure if the receiver display shows "SYNC FAIL".
3. Check the audio.  
*"SCANNING" will only be displayed if auto-scan is enabled.*

## Reading the Handheld Mic and Beltpack LCD:

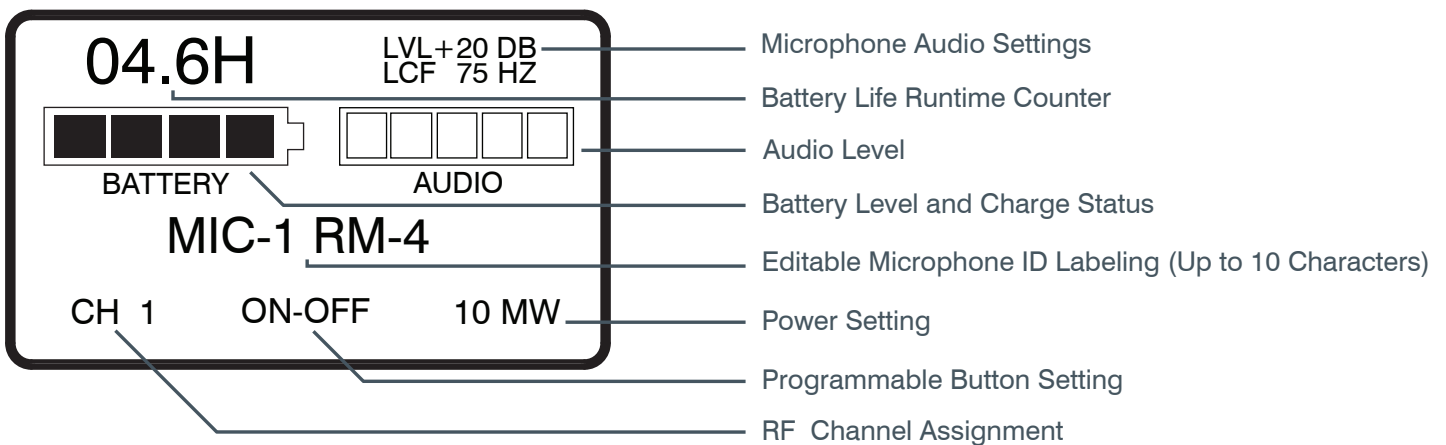

# Reading the Transmitter LED:

Gooseneck Podium Mic and Table-top Boundary Mic in use, or when being charged via USB:

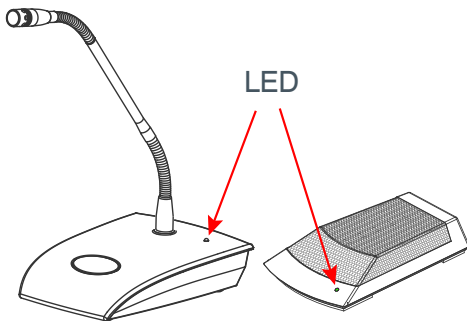

Battery Power or USB Power:

In Use:

- **RED** = AUDIO MUTED
- **GREEN** = AUDIO PASS
- **BLINK GREEN** = SYNC
- **BLINK RED** = LOW BAT

Charging Status:

- **RED** = NOT CHARGED
- **AMBER** = CHARGING
- **GREEN** = CHARGED

The Podium Gooseneck Battery Cassette when charged in the dock:

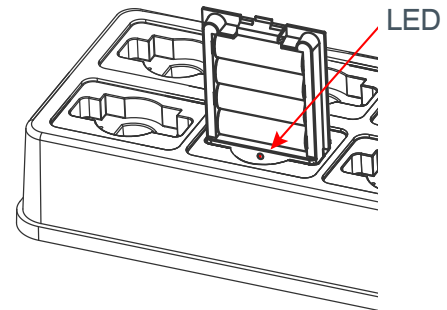

Charging Status:

- **RED** = CHARGING
- **OFF** = CHARGED

*Charging Dock is an optional accessory.*

Table-top Boundary Mic when it is charged in the Dock:

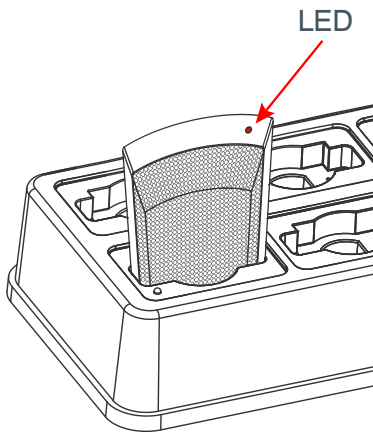

Charging Status:

- **RED CHANGE TO AMBER** = CHARGING
- **GREEN** = CHARGED
- **GREEN & RED BLINK** = CHARGING ERROR  
(RE-SEAT TRANSMITTER / CHECK BATTERIES)

The Handheld and Beltpack when in use, charged via USB, or charged in the Dock:

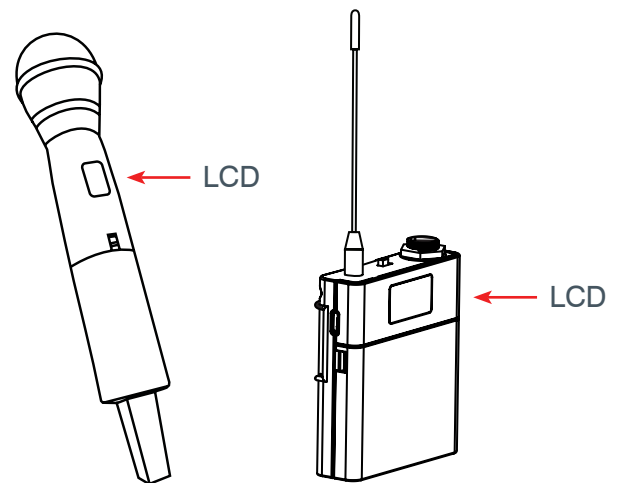

In Use and Charging Satus:

THE LCD SHOWS THE BATTERY LIFE AND CHARGING STATUS (See pg. 4)



---

<b>Headquarters</b> 5225 Wiley Post Way Suite 500 Salt Lake City, UT. 84116	<b>US &amp; Canada</b> Tel: 801.975.7200 Toll Free: 800.945.7730 Fax: 801.303.5711	<b>International</b> Tel: +1.801.975.7200 Email: global@clearone.com	<b>Sales</b> Tel: 801.975.7200 Email: sales@clearone.com	<b>Tech Support</b> Tel: 801.974.3760 Email: tech.support@clearone.com	<b>Antenna Design</b> Tel: 386.361.8134 Email: antenna.design@clearone.com
---	---	--	--	--	--

Other product names may be registered trademarks of their respective owners who do not necessarily endorse ClearOne or ClearOne's products. All rights reserved.  
Information in this document subject to change without notice. © 2021 ClearOne. QSG-0138-001 ClearOne\_DIALOG20\_Transmitter\_QuickStartGuide-V1.0 September 21, 2021